

SEE MAP "6E" FOR AREA

OWNER	SECTION	DIV.	NUMBER	REAL ESTATE REGION
500	3070	-	1-20	7

No.	Grantee	Instrument	Date	Record	Cur. No.	Remarks	Grantee	Instrument	Date	Record	Cur. No.
1	Z.B.W. Ry Co	K.B.M. Ry Co	Dec. 31, 1930			Formerly Z.B.W. V.S. 2. Map 16 Par 12	Peletiah W. Huntington	W. Deed	Nov. 28, 1892	DB V48 P251	Dec. 16, 1902
2	do	do	do				L.R. Drake	W. Deed	June 26, 1896	DB V71 P471	July 2, 1904
3	do	do	do				Ralph Drake, et al	W. Deed	Nov. 23, 1898	DB V45 P226	Feb. 27, 1897
4	do	do	do				S.B.M.P. Ry Co	W. Deed	May 23, 1898	DB V45 P416	Feb. 24, 1897
5	do	do	do				do	R/W Deed	Oct. 8, 1897	DB V45 P412	Feb. 24, 1897
6	do	do	do				Nelson L. Rodgers	Lease	do	do	do
7	do	do	do				W.L. Deaver	do	do	do	do
8	do	do	do				Henry Rice	do	do	do	do
9	do	do	do				Joshua Rodgers	do	do	do	do
10	do	do	do				do	do	do	do	do
11	do	do	do				Orphe E. Epler	do	do	do	do
12	do	do	do				Presley T. McArthur	do	do	do	do
13	do	do	do				do	do	do	do	do
14	K.B.M. Ry Co	State of Ohio	Nov. 5, 1937		100	A.F.E. 44663	M.L. Deaver	C.S.B.H. Ry Co	do	do	do

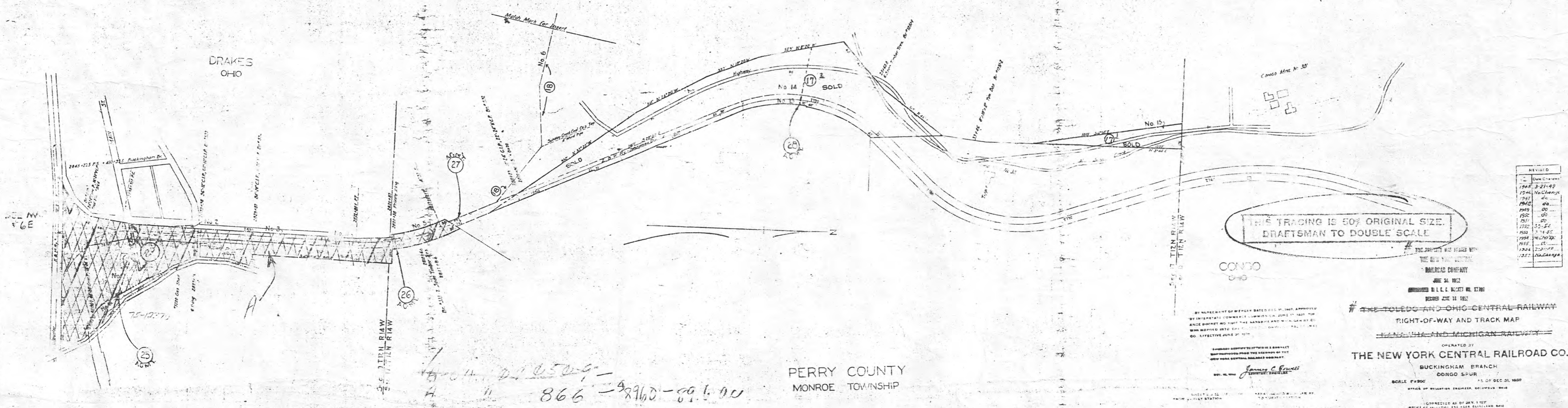

THIS TRACING IS 50% ORIGINAL SIZE. DRAFTSMAN TO DOUBLE SCALE

REVISED	DATE	BY
1945	3-21-45	D.M. Chaves
1946	do	do
1947	do	do
1948	do	do
1949	do	do
1950	do	do
1951	do	do
1952	do	do
1953	do	do
1954	do	do
1955	do	do
1956	do	do
1957	do	do

THE PROPERTY WAS DEEDED BY THE NEW YORK CENTRAL RAILROAD COMPANY  
 JUNE 31, 1902  
 RECORDED IN L. & C. BOOK NO. 1796  
 SERIES 206 11 1897

BY AGREEMENT OF WHICH DATED FEB. 11, 1901, APPROVED BY THE BOARD OF DIRECTORS OF THE NEW YORK CENTRAL RAILROAD COMPANY AND THE BOARD OF DIRECTORS OF THE TOLEDO AND OHIO CENTRAL RAILROAD COMPANY, THE TRACKS AND RIGHT-OF-WAY WERE BEQUEATHED INTO THE POSSESSION OF THE NEW YORK CENTRAL RAILROAD COMPANY, EFFECTIVE JUNE 30, 1901.

OPERATED BY  
**THE NEW YORK CENTRAL RAILROAD CO.**  
 BUCKINGHAM BRANCH  
 CONGO SPUR

SCALE 1"=200' AS OF JAN. 1, 1907  
 OFFICE OF SURVEYOR GENERAL, COLUMBUS, OHIO

1 CORRECTED AS OF JAN. 1, 1907  
 OFFICE OF SURVEYOR GENERAL, COLUMBUS, OHIO

PERRY COUNTY  
 MONROE TOWNSHIP

866-8960-8960