

PERRY COUNTY READING TOWNSHIP  
SECTION 10, TOWNSHIP 16, RANGE 16

BEGIN PROJECT  
STA. 1480+50.00  
S.L.M.=28.04

END PROJECT  
STA. 1482+25.00  
S.L.M.=28.08

1479+00 + 1480+00 + 1481+00 + 1482+00 + 1483+00 + 1484+00 + 1485+00 + 1486+00  
N 40°00'00" W  
C SURVEY & CONSTRUCTION S.R. 13

SECTION 10

SECTION 9

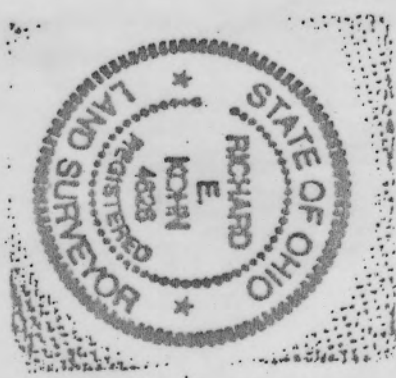
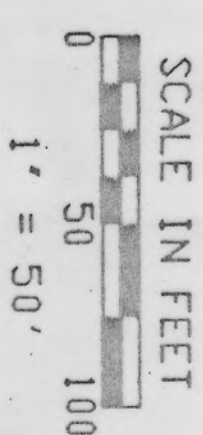

I HEREBY CERTIFY THAT THIS PLAT AND DESCRIPTIONS  
WERE PREPARED BY ME FROM SURVEY DATA FURNISHED  
BY THE STATE OF OHIO, DEPARTMENT OF TRANSPORTATION  
IN 1990/1991  
BY

DISTRICT 5, OHIO DEPARTMENT OF TRANSPORTATION

Richard E. Kuhn July 14, 1992  
Registered Surveyor NO. 4626 DATE

Received July 8, 1995 AT 1:35 PM  
RECORDED FILE # 294 B  
PLAT BOOK 5 PAGES 98

SIGNED Barbara J. Kuhn PERRY COUNTY, OHIO

William A. Cune Perry County Commissioner

Heidi J. Dawson Perry County Auditor

Approved by: [Signature] Perry County Auditor

[Signature] Perry County Auditor

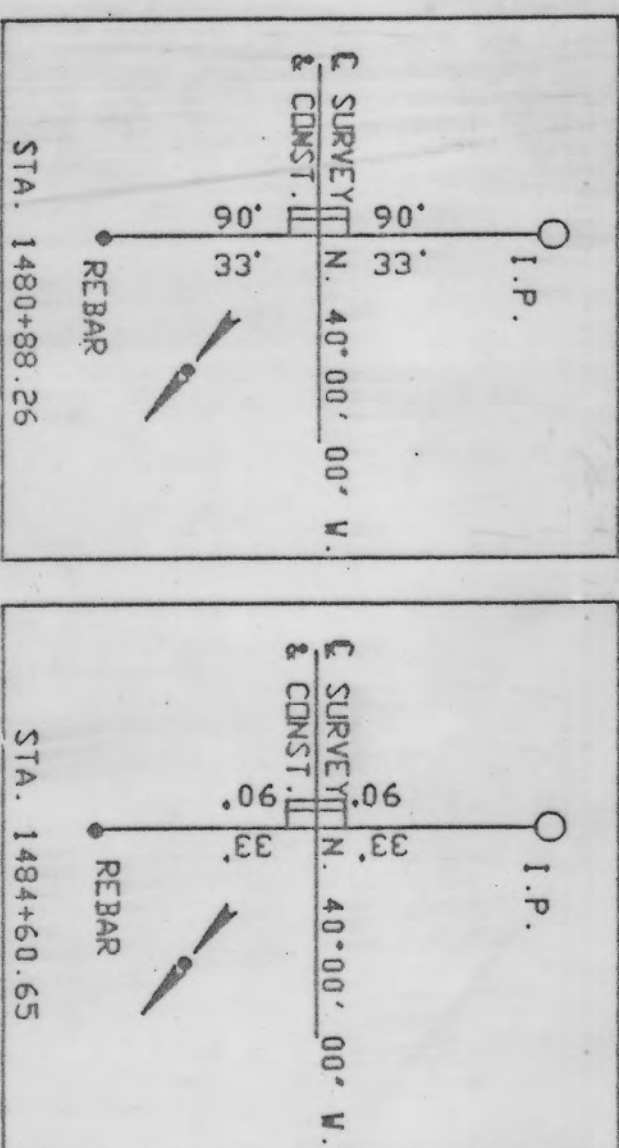

5/8" X 30" REBAR WITH CAP ARE TO BE  
PLACED ON THE RIGHT-OF-WAY AT THE  
FOLLOWING LOCATION BEFORE CONSTRUCTION.

STA. 1478+46.40	956.25 LT.	STA. 1481+20.05	198.00 RT.
STA. 1479+37.28	586.74 LT.	STA. 1481+02.63	33.00 RT.
STA. 1479+46.92	589.24 LT.	STA. 1482+34.05	198.00 RT.
STA. 1479+54.13	865.76 LT.	STA. 1482+34.63	33.00 RT.
STA. 1480+24.08	610.38 LT.		
STA. 1480+33.72	613.02 LT.		
STA. 1480+88.90	33.00 LT.		
STA. 1481+92.58	33.00 LT.		

TOTAL NUMBER OF:

- 8 OWNERSHIPS
- 3 TOTAL TAKES
- 0 OWNERSHIPS WITH STRUCTURES INVOLVED
- 0 OWNERSHIPS WITH 'P' ITEMS

# SUMMARY OF ADDITIONAL RIGHT OF WAY

PARCEL	OWNER	SHEET NO.	OWNERS RECORD		RECORD AREA	TOTAL P.R.D.	GROSS TAKE	P.R.D. IN TAKE	NET TAKE	STRUC-TURE	NET RESIDUE		TYPE FUND	AUDITOR'S PARCEL NO.	REMARKS
			BOOK	PAGE							LEFT	RIGHT			
1-T	Anna Litzinger	3	D.R.38	401	0.308AC	0.000AC	0.002AC	0.000AC	0.002AC	ND	0.308AC		STATE	32-402-00-00	TD CONSTRUCT SLOPEWORK
2-VD	Edward R. Magruder	3	D.B.8	184	1.046AC	0.000AC	1.046AC	0.000AC	1.046AC	ND	0.000AC		STATE	032-008001-01-000	
3-VD	John Law	3	D.B.F	583	0.186AC	0.000AC	0.186AC	0.000AC	0.186AC	ND	0.000AC		STATE	032-008001-01-000	
4-T	John & Carol Emmert	3	D.R.65	161	0.541AC	0.000AC	0.009AC	0.000AC	0.541AC	ND	0.541AC		STATE	32-000-189	
5-VD	Samuel Shearer	3	D.B.3	329	0.216AC	0.000AC	0.216AC	0.000AC	0.216AC	ND	0.000AC	0.000AC	STATE	032-008001-01-000	
6-VD	George Schmit	3	D.B.0	38	0.250AC	0.000AC	0.250AC	0.000AC	0.250AC	ND	0.000AC	0.000AC	STATE	032-008001-01-000	
7-VD	Eli A. Spencer	3	D.B.Y	116	0.281AC	0.000AC	0.281AC	0.000AC	0.281AC	ND	0.000AC		STATE	032-008001-01-000	
8-VD	Thomas E. Johann Rouse & Thomas Johnson	4	D.R.1	790	2.302AC	0.000AC	0.429AC	0.000AC	0.429AC	ND	1.873AC		STATE	32-000-542	