

# S L Kishler's Addition to New Lexington, Ohio.

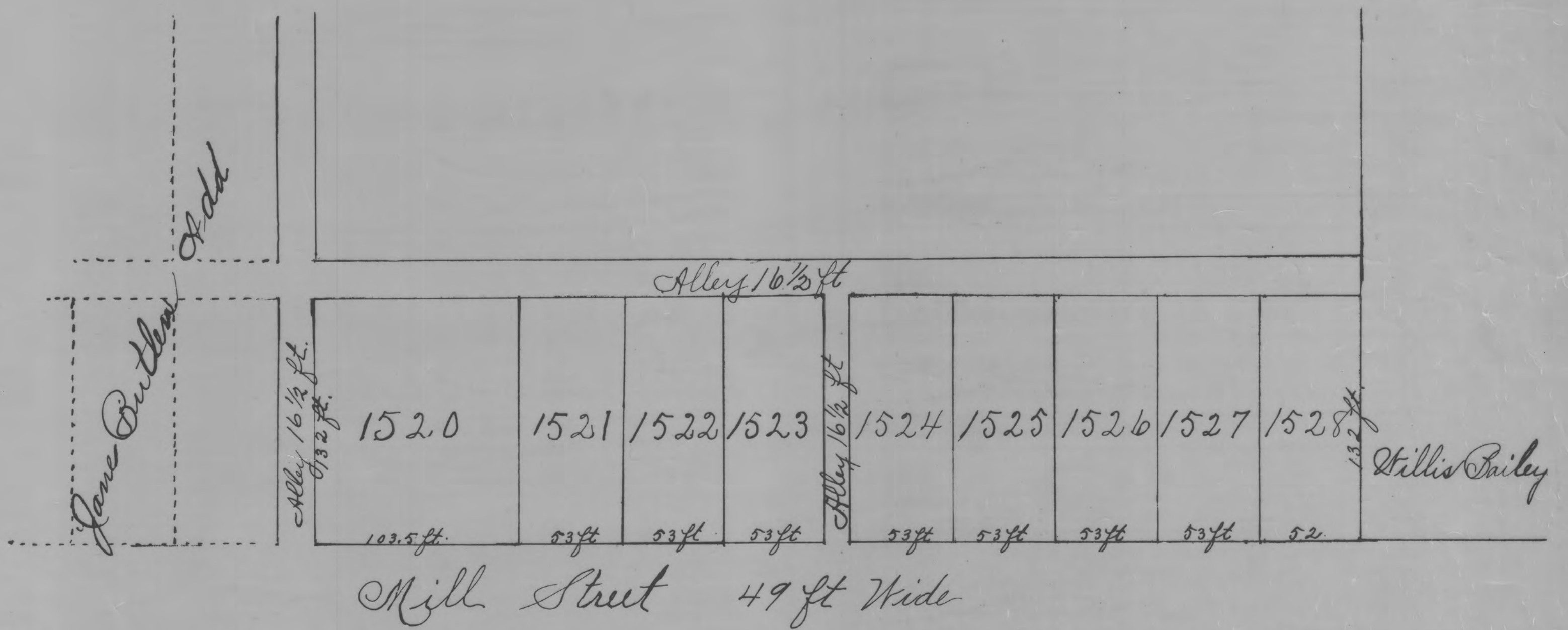

J. J. Tracys

Addition

Childrens Home

Scale... 50 ft to 1 inch

This tract is a part of the North East quarter of Section No. 9 Township No. 15. Range No. 15. Perry County Ohio.

Beginning at the South west corner of said quarter section. Thence East 1583 ft. Thence North 24 feet and 9 inches, to the place of beginning. Thence north 148.5 feet. Thence East 559.5 feet. Thence South 148.5 ft. Thence West 559.5 feet to the place of beginning

Containing 1 1/10 Acres

March 19th 1910

John Avery - C.E.

We, the undersigned, owners of the land platted and shown on this plat of survey, do hereby assent to and adopt the same, and the same was made at our request.

The Streets and alleys as shown on this plat we hereby dedicate to public use

Signed and acknowledged in our presence.

J. B. Williams  
Kate Kishler.

Sarah L. Kishler  
Nelson M. Kishler.

The State of Ohio, Perry County, ss. Before me a Notary Public, in and for said County, personally appeared the above named Sarah L. Kishler and Nelson M. Kishler and acknowledged that they did sign the foregoing plat and that the same is their voluntary act and deed for the uses and purposes therein mentioned.

In Testimony Whereof I hereunto subscribed my name and affixed my official seal this 21 day of March 1910

[Seal]

J. B. Williams, Notary Public

Rec. for Record March 21, 1910  
at 9:25 A.M.  
Recorded March 21, 1910

J. W. Baird, Recorder  
R. E. R. 101