

Section Line Between Sec 17 and 20 and 16 and 21

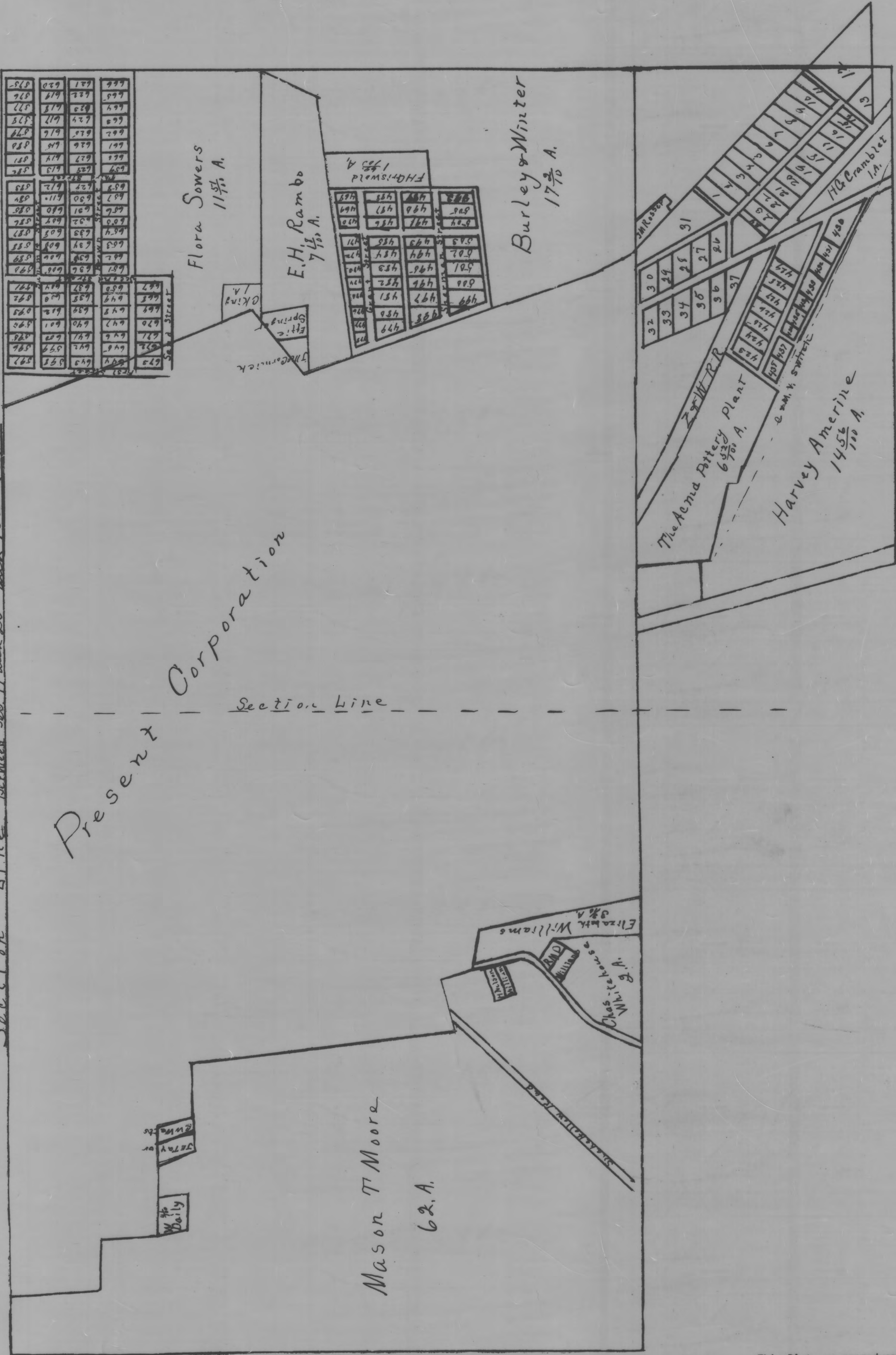

The outside boundary of this tract begins at the north East corner of the north west quarter of Sec 16, T20, R16, N14 Range No 14 Perry County, Ohio. Thence north 2648 ft. Thence west 1810 ft. Thence east 366 1/2 ft. Thence south 1785 ft. Thence west 2640 ft. Thence south 1320 ft. Thence east 1320 ft. Thence west 1320 ft. Thence east 1320 ft. Thence south 2640 ft. Thence east 2960 ft. Thence south 1065 ft. Thence east 2065 ft. Thence north 8650 ft. to the place beginning containing recording of present Corporation, 568 1/2 ac. Acq'd.

This Plat was reproduced thru the joint cooperation of T. Chris Wilson, Perry County Engineer and Nancy C. Howdysshell, Perry County Recorder

ATTEST: A Reproduction of Plat Book No. 3

June, 1981

Nancy C. Howdysshell
Perry County Recorder