

FATES' ADDITION TO NEW LEXINGTON,

BIKE Tp.
Perry County, - Ohio.

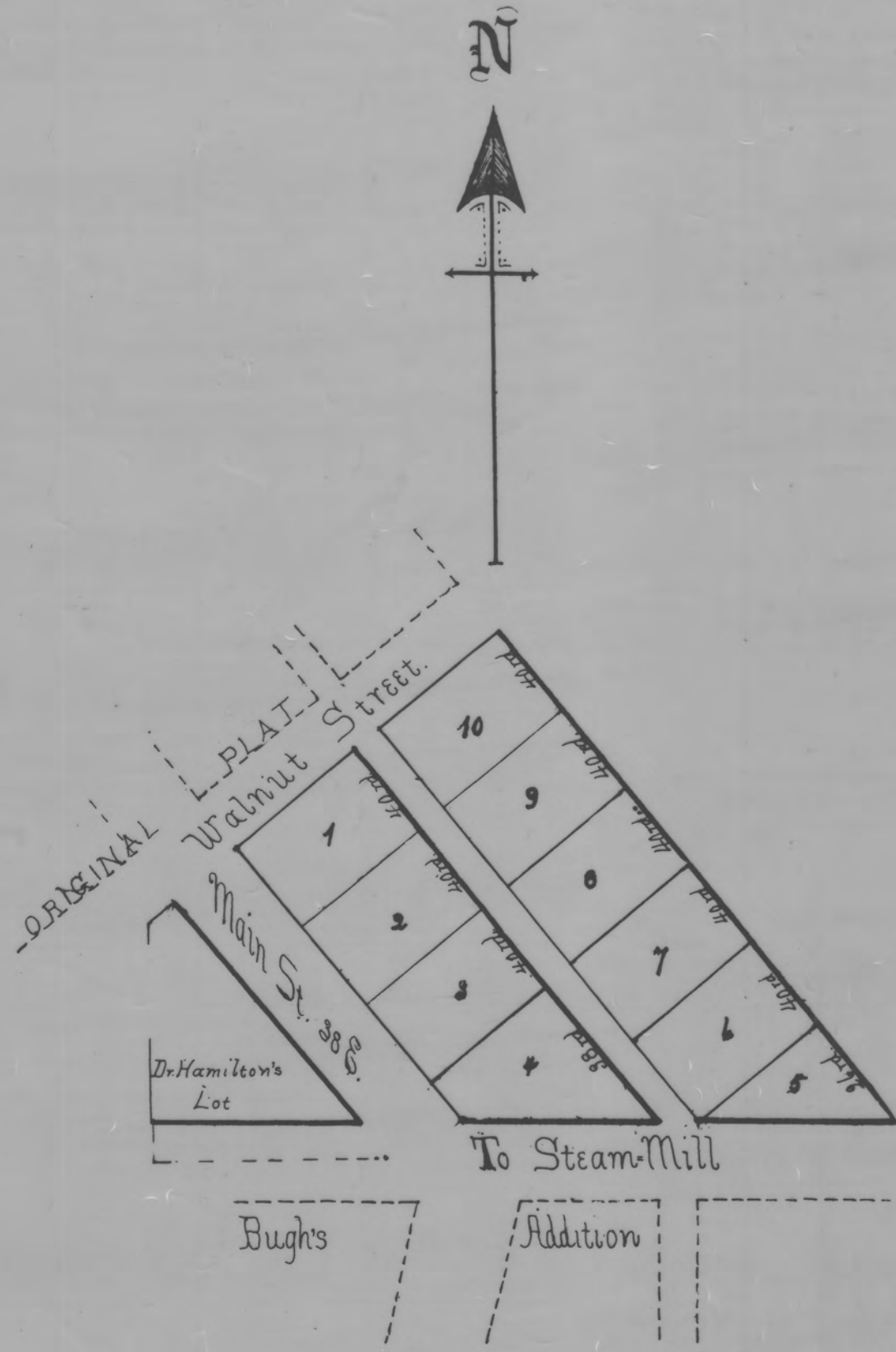

Fates Addition to New Lexington is located in the south west quarter of the north east quarter of Section number 9 of Range No. 15 & Township No. 15, of lands directed by act of Congress to be sold at Zanesville. Commencing at a stone marked N at the intersection of Main Street & Walnut on the south side of Walnut & East side of Main. Each lot is 125 links in front and 200 links deep, containing forty square rods excepting lot No. 4 which contains only thirty eight rods and No. 5 which contains 26 rods as may be seen on the Plat. I hereby certify the above to be a correct plat as taken this 9th of Sept. A.D. 1845.

Received May 29th 1846 Recorded June 18th 1846. Attest Jacob Britigan Recorder

The State of Ohio Perry County ss I Henry Sherlock Recorder of said County, do hereby certify the foregoing plat and description of Fates Addition to New Lexington to be a full and true copy as found recorded in book 2, page 414. Transferred August 16th A.D. 1853 by order of the Commissioners.

This Plat was reproduced thru the joint cooperation of T. Chris Wilson, Perry County Engineer and Nancy C. Howdysshell, Perry County Recorder

ATTEST: A Reproduction of Plat Book No. 2
Nancy C. Howdysshell
 Nancy C. Howdysshell
 Perry County Recorder